

## Ceiling to Floor for Shelving Kit

### Cable Installation

#### 1 Detach Parts A1 and B5

AS31ST  
Ceiling To Floor Kit



Cable  
D1.5mm (1/16")  
1.6m (19ft)

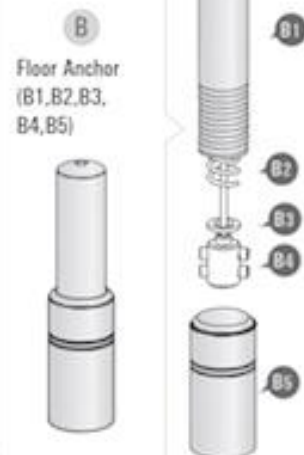

#### 2 Mount A1 to the ceiling

Recommended screw type:  
Flat Head Screw 5mm (1/10)

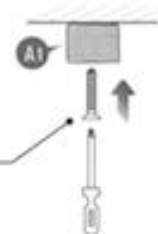

Note:  
Use appropriate  
fastening hardware  
depending on the  
type of ceiling.

#### 3 Mount part B5 to the floor directly below ceiling connector

Recommended screw type:  
Flat Head Screw 5mm (1/10)



#### 4 Fasten A2 to A1 and securely tighten

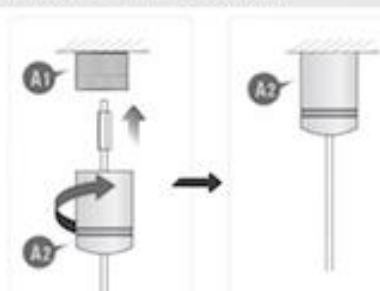

#### 5 Firmly stretch the cable towards the slit in B5 and mark the cut line as illustrated, without cutting the cable



#### 6 Loosen all 4 screws in Part B4

Push parts B1, B2, B3 and B4 through the cable until B4 passes the marked line and cut the cable at marked point

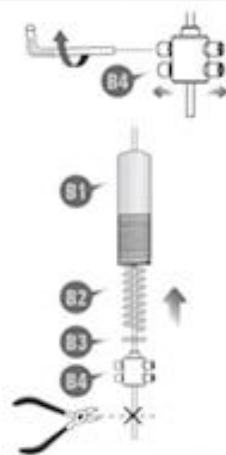

#### 7 Fasten B4 so that the tip of the cable extends an additional 3mm (1/8")

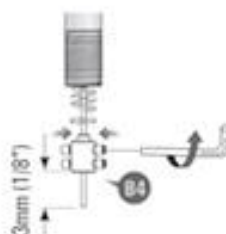

#### 8 Firmly stretch the cable in place using the built in tensioner to fasten B1 to B5 until threaded surface is no longer visible

Repeat steps 2-7 to install all the cables

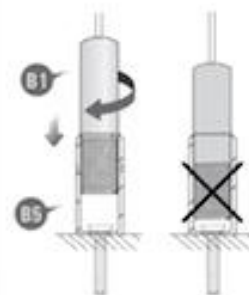

General Note: It is the responsibility of the purchaser and/or installer to verify that the mounting surface is solid and capable of supporting the intended weight of display. It is recommended that a professional is consulted to determine the appropriate fastener/anchor needed for the mounting surface. The manufacturer is solely responsible for the quality of its products and not accountable for faulty installation and misuse of its products beyond recommended limitations.

## Ceiling to Floor for Shelving Kit

### Adding Shelves

- 1** Place all Parts C on the left side cables at required heights and tighten

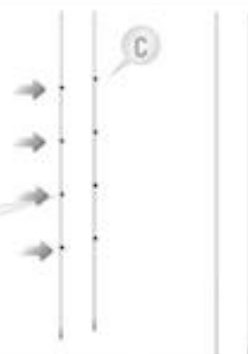
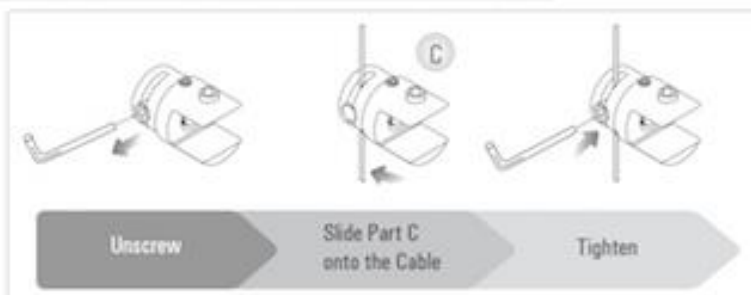

- 2** Place Parts C on right side cable at the required heights. Fasten and loosely secure but **DON'T TIGHTEN YET**

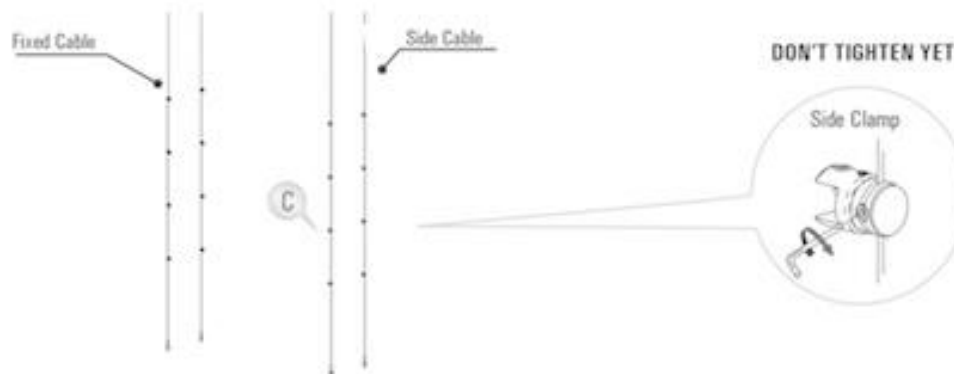

- 3** Slide in the shelf to all 4 Parts C



- 4** Tighten the shelf connectors with Allen key



- 5** Loosen the screw on right cable. Adjust until level

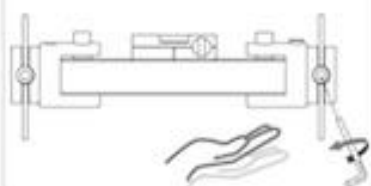

- 6** Tighten all screws on the cable with Allen key

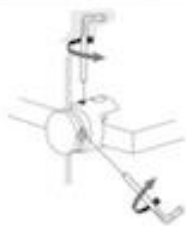

**Maintenance:**  
Tighten all screws in the setting every 6 months, or more as needed.

**General Note:** It is the responsibility of the purchaser and/or installer to verify that the mounting surface is solid and capable of supporting the intended weight of display. It is recommended that a professional is consulted to determine the appropriate fastener/anchor needed for the mounting surface. The manufacturer is solely responsible for the quality of its products and not accountable for faulty installation and misuse of its products beyond recommended limitations.